

SCPV - TEMPEST Inline Filter - 16AIL19 For 19" Rack

Silicon CPV's inline, TEMPEST filter has been designed for use within stringent TEMPEST environments and applications, where protection compliant to SDIP-29 and equipment hardening to SDIP-27 is required.

The product uses ultra-reliable self-healing capacitors, in all units to deliver optimum performance across the full frequency range and under all loading conditions.

The SCPV filter has been designed for use within unprotected power environments to ensure deployment and electrical installation is as quick and simple as possible.

The product has been designed to support current ratings of **16 Amps** under single phase operating voltage conditions.



Description



- TEMPEST EMI SP & N filter providing performance to SDIP-27 B/C
- Insertion loss of 60dB from 100kHz to 1GHz
- **2m, 3 core shielded flex cable for input / output connectivity**
- Designed to IT equipment safety standard EN 62368-1
- Fully 360° screened input cable to maintain red/black separation to filter
- Low Smoke Zero Halogen (LSZH) rated cabling for use in sensitive areas
- Self-healing metallised plastic film capacitors
- High common & differential mode insertion loss
- Improved low frequency performance
- Powder coated aluminium enclosure
- 16A designs of filter are downline tolerable to a personnel protection RCCD
- CE compliant
- Simple mechanical and electrical installation
- Filters comply with basic requirements of the EMC directive 2014/30/EU

Ratings and Characteristics

Rated Voltage	230V AC 50/60Hz
Test Voltage (line-earth)	2250V DC
Test Voltage (line-Line)	1250V DC
Rated Current @50°C	16A
Earth Leakage Current	Less than 3.0mA
Max Temp Rise @Full Load	<35°C

Storage Temp Range	-25°C to 85°C
Operating Temp Range	-20°C to 50°C
Insertion Loss (50Ω Asymmetric)	60dB, 100KHz - 1GHz
Discharge Time	Less than 1s to below 34V
Enclosure	Extruded Aluminium
Finish	Powder coated

Dimensional Data

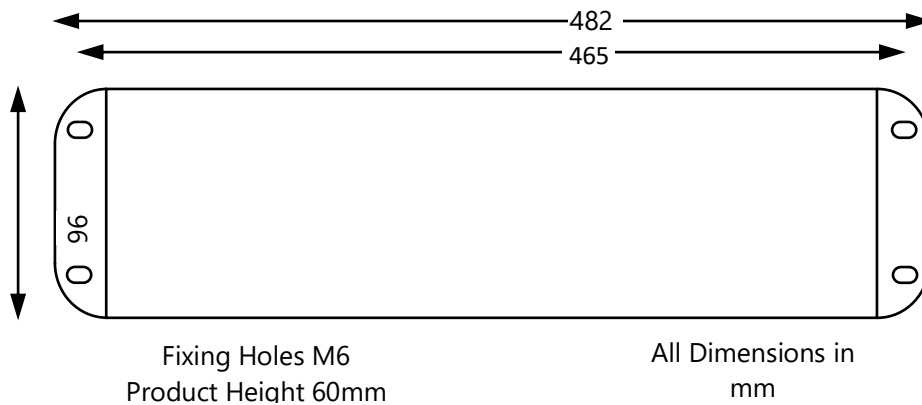

19" Rack Mount



Performance Characteristics and Insertion Loss Curves

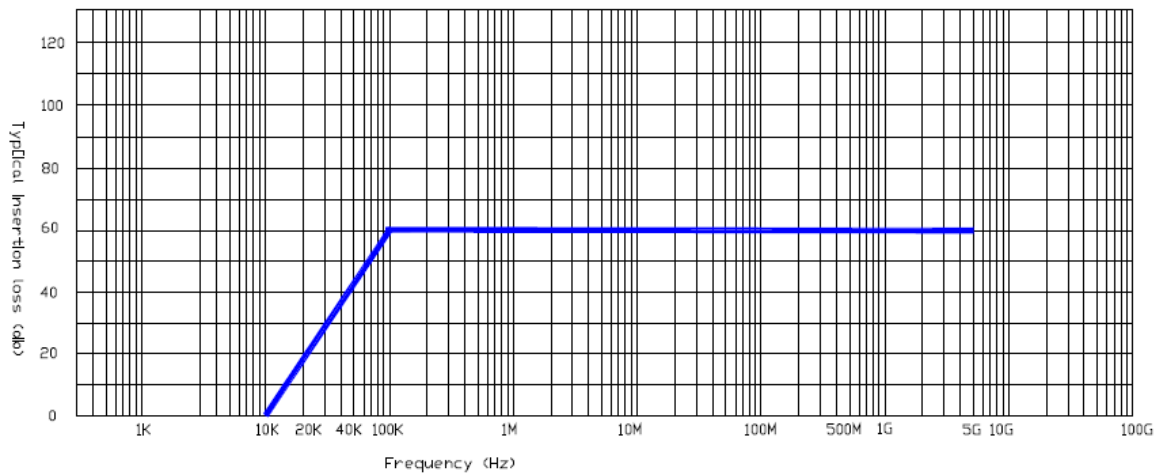

Part No and Ordering Information

Part No	Product Description
SCPV-TEMPEST-16AIL19 CP&F Part No: SCPVTEMPEST16AIL19	19" Rack, Inline 16A Single Phase 230V Filter